



 H. RISHABRAJ  
**PERCY**  
BORIVALI [W]

Where your  
passion  
for living  
blooms...



STOCK IMAGE

Welcome to Rishabraj Percy, a contemporary living destination that brings modern living spaces cocooned in luxurious detailing and environment right to the heart of the city. Primed and positioned in the pristine residential locales of I.C. Colony, Borivali West, the project offers a choice of 2 & 3 bhk apartments designed to provide excellent space management, with tastefully designed interiors that mark the essence of every home. The project boasts of a smartly conceived blend of urban planning and perfect harmony with one floor of commercial space and 9 floors of well planned residential abodes on the upper levels.

The tower is a beautiful homage to aesthetically designed living areas and well planned amenities that convey feelings of comfort and absolute convenience. With easy accessibility and proximity to major roadways, basic social infrastructure such as healthcare and education facilities, the location is perfect for those looking for a little respite from the everyday bustle.



ARTIST'S IMPRESSION



# Let the good times roll in...

Step into the lobby which boasts to be a glamorous extension of the opulence and luxury reflected and echoed throughout every corner of the tower. Designed for those who want to make living a truly enthralling experience, get ready to revel every minute, in a celebration called life...



## External Facilities

- Designer Entrance Lobby.
- High speed elevators of a reputed brand.
- Puzzle Parking
- Fitness Center
- Terrace Garden
- Chequered tile / pavers in the entire compound.
- CCTV surveillance in common area.

## Internal Amenities

- Vitrified flooring in entire flat.
- Colour anodized Aluminium sliding windows with tinted glass and marble frame.
- Granite double kitchen platform with Stainless steel sink.
- Concealed copper wiring with Goldmedal switches and accessories with E.L.C.B.
- Designer bathroom with anti skid ceramic tile flooring.
- Concealed plumbing with superior quality sanitaryware and Jaquar fittings or any similar brand.

With a clear height of 11 feet... enjoy your space that's LIMITED EDITION

FLAT NO.	TYPE	RERA CARPET AREA
1	2 BHK	537 SQ. FT.
2	2 BHK	629 SQ. FT.
3	3 BHK	856 SQ. FT.

TYPICAL FLOOR PLAN



10m

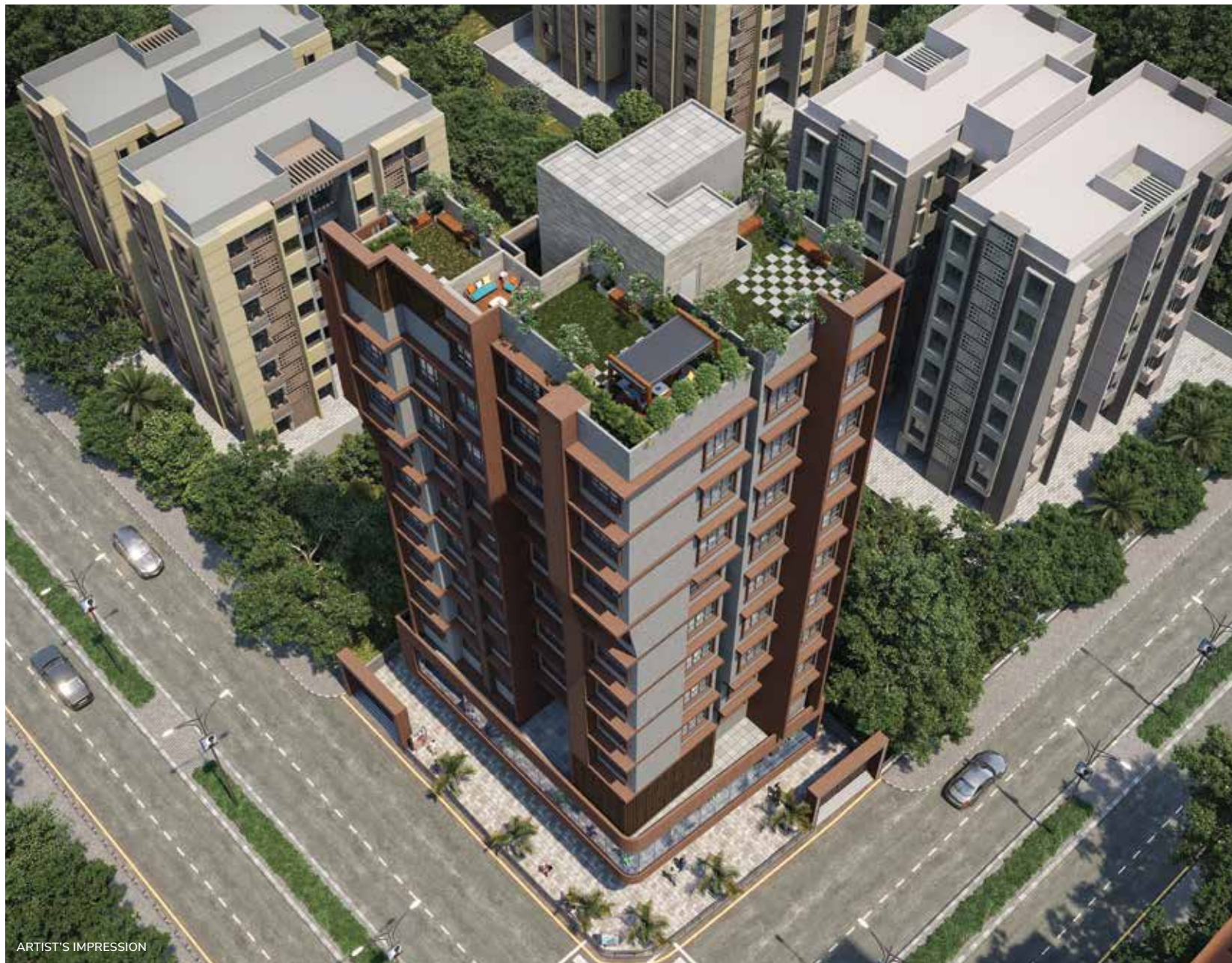

ARTIST'S IMPRESSION



1ST FLOOR PLAN



ARTIST'S IMPRESSION

Soak in the good life...

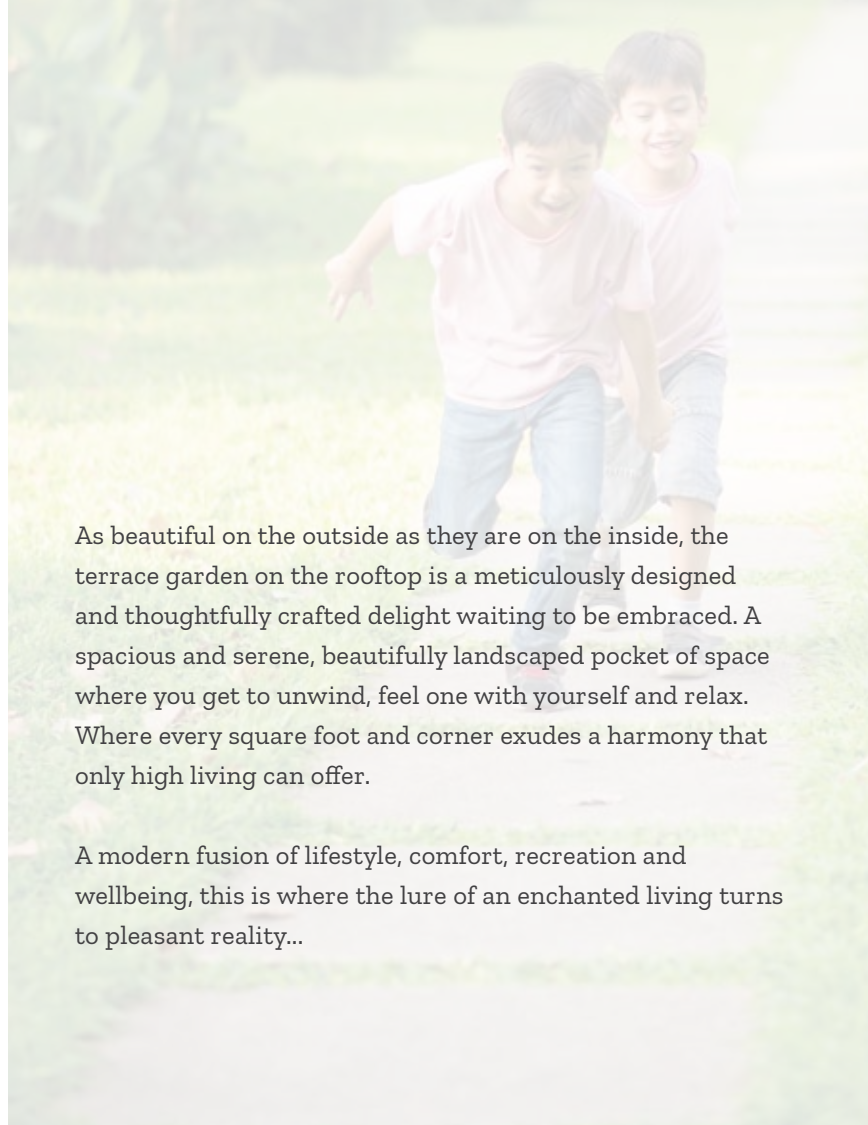

As beautiful on the outside as they are on the inside, the terrace garden on the rooftop is a meticulously designed and thoughtfully crafted delight waiting to be embraced. A spacious and serene, beautifully landscaped pocket of space where you get to unwind, feel one with yourself and relax. Where every square foot and corner exudes a harmony that only high living can offer.

A modern fusion of lifestyle, comfort, recreation and wellbeing, this is where the lure of an enchanted living turns to pleasant reality...



ARTIST'S IMPRESSION

**H.RISHABRAJ**  
**PERCY**  
BORIVALI [W]



ARTIST'S IMPRESSION



Site Address : Rishabraj Percy, Road No. 2, I.C. Colony, Borivali West, Mumbai - 400 103



Trust, quality, customer satisfaction, and goodwill are values that are today synonymous with the Rishabraj brand. With Mr. Harrishkumar Jain at the helm of the company, the group has succeeded in translating millions of wishes into reality. The earnest dedication and rising momentum of the company has resulted in the group setting new yardsticks in the redevelopment niche. With glowing testimonials from 1000 + ecstatic families spread over 1 million sq.ft of premium living space happily under its belt, the Group continues to carry forward its never ending passion for excellence with 1.5+ million sq. ft under various stages of planning & construction.

[www.hrishabraj.com](http://www.hrishabraj.com)



In the city of Mumbai most projects are in dire need of revamping or construction work on booked projects is stalled. This shatters the precious dream of millions who wish to live the ultimate life in this city of dreams.

Is there no respite in sight for such scenarios? Is there a possibility of a saviour emerging from the very belly of this magnificent city to help fix this huge problem? Well, the answer is a resounding Yes!

The innovative genius of H Rishabraj gave birth to a revolutionary brand in the year 2020. We are Let's Restart and Welcome to the ultimate solution provider for delayed construction projects.

[www.letrestart.com](http://www.letrestart.com)

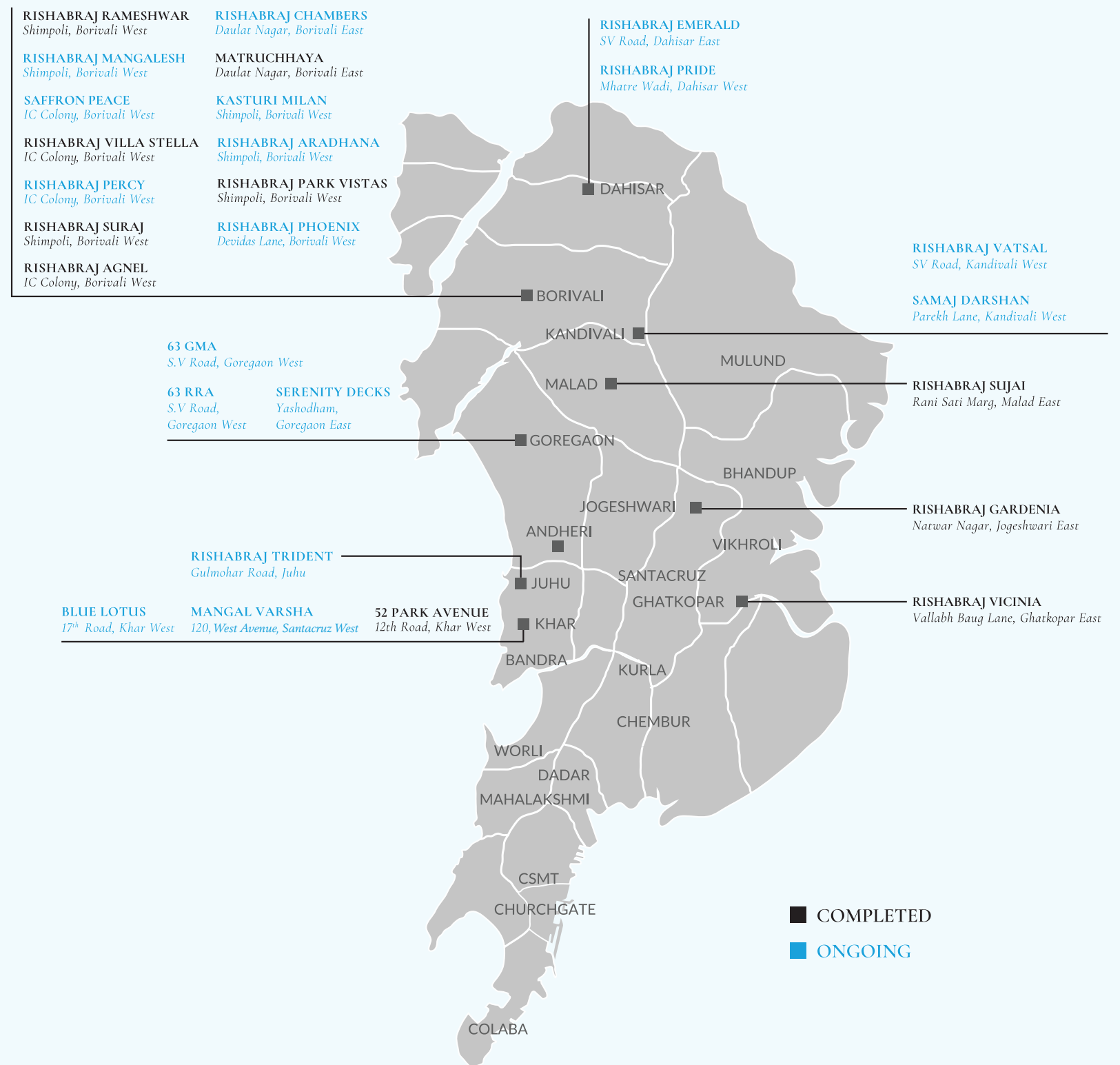

## Other Projects



ARTIST'S IMPRESSION  
**BLUE LOTUS - Khar W**  
MahaRera No. P51800033826



ARTIST'S IMPRESSION  
**RISHABRAJ PARKVISTAS - Borivali W**  
MahaRera No. P51800033442



ARTIST'S IMPRESSION  
**RISHABRAJ PHOENIX - Borivali W**  
MahaRera No. P51800033878



ARTIST'S IMPRESSION  
**RISHABRAJ AGNEL - Borivali W**  
MahaRera No. P51800030530



ARTIST'S IMPRESSION  
**RISHABRAJ SAMAJ DARSHAN - Kandivali W**  
MahaRera No. P51800010479



ARTIST'S IMPRESSION  
**RISHABRAJ VATSAL - Kandivali W**  
MahaRera No. P51800034973

A Project by



# H. RISHABRAJ

ENERGIZING HAPPINESS!

Developers : **H RISHABRAJ REALTY**

Corporate Address : 103, Jai Tirth, Daulat Nagar,  
Road No 10, Borivali (East), Mumbai - 400066

Ph : 022 2893 4545 | 2893 4747

Sales : 9004887224 | 7208584858

E : sales@hrishabraj.com W : www.hrishabraj.com

A Proud Member of



MahaRera number : P51800034819 (<https://maharera.mahaonline.gov.in>)

Disclaimer : The plans, specifications, amenities, facilities, images and other details herein are only indicative and the developer's reserve their rights to change any of all of these in the interest of the development. This printed material does not constitute an offer and or contract any type between the developer and the recipient. Any purchase of this development shall be governed by the terms and conditions of the agreement for sale/ lease entered into between parties and no detail mentioned in this printed material shall in any way govern such transaction.